

MODEL 163.113 /128 /136 /154 /157 /172 /174 /175

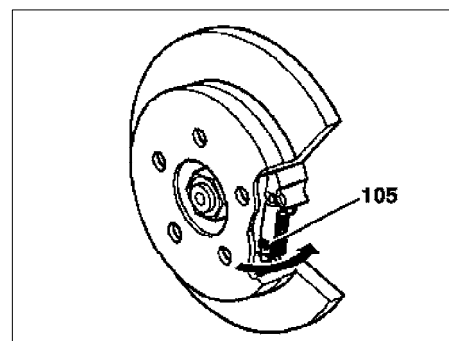

P42.20-0295-01

Modification notes

13.12.02	Safety information on lifting platform, incorporated for the first time		AS00.00-Z-0010-01A
13.12.02	Check version of pedal assembly, included for the first time	Step 1	BT42.20-P-0510-01A

	Inspect		
	Danger!	Risk of death. Death may result if vehicle slips or topples from the lifting platform.	Align vehicle between the columns of the hydraulic hoist and position the four support plates below the hoist support points specified by the vehicle manufacturer.
		Notes on repairs to brake system	AS00.00-Z-0010-01A
1 	BT	Check version of pedal assembly Parking brake pedal assembly modified	BT42.20-P-0510-01A
2		Operate parking brake pedal and check pedal travel of parking brake pedal	If the pedal travel is not within the tolerance range: ~ Adjust parking brake. Control force on parking brake pedal Number of notches that parking brake pedal has to be pressed
	Remove		*BE42.20-P-1001-01C *BE42.20-P-1002-01C
3 	AP	Unscrew one wheel bolt on the left and right rear wheel Remove/install wheels, rotate if necessary.	Light alloy wheels must be removed due to the risk of damage. AP40.10-P-4050GH
4		Preload automatic cable slack adjuster	AR42.20-P-0520-01A
	Adjusting		
5		Using a screwdriver, rotate the adjusting wheel (105) until the brake shoes abut the parking brake drum and the rear wheel or the brake disk can no longer be turned by hand.	Adjustment direction for applying the brake shoes: Turn left and right adjusting wheel (105) from left to right.
6		Turn back the adjusting wheel (105) until the rear wheel or brake disk can be turned completely freely by hand.	When releasing the adjusting wheels (105) ensure that the left and right adjusting wheels (105) are turned back by the same number of teeth (approx. 5 teeth).
7		Release automatic slack adjuster	AR42.20-P-0520-02A
	Inspect		
8		Operate parking brake pedal several times and check pedal travel of the parking brake pedal, then release the parking brake	Control force on parking brake pedal Number of notches that parking brake pedal has to be pressed
9		Check unobstructed movement of rear wheels or brake disks	*BE42.20-P-1001-01C *BE42.20-P-1002-01C
	Install		
10 	AP	Fit wheel bolts or light alloy wheels Remove/install wheels, rotate if necessary.	AP40.10-P-4050GH

Adjusting values for parking brake

Number	Designation		Model 163, Pedal assembly with pulled notch	Model 163, Pedal assembly with pushed notch
BE42.20-P-1001-01C	Control force on parking brake pedal	N	170 (-50/+70)	170 (-50/+70)
BE42.20-P-1002-01C	Number of notches that parking brake pedal has to be pressed	Quantity	1	5
		See fig.	BT42.20-P-0510-01A	BT42.20-P-0510-01A

MODELS 129, 140, 163, 202, 203, 208, 209, 210, 211, 215, 220, 230, 240**Modified pedal assembly**

Phased in as of approx. 09/2002 a modified design of parking brake pedal systems (1) have been fitted.

The new version of the pedal assembly (1) has a pulled notch (2a) instead of a pushed notch (2b) as previously.

This results in different values for the adjustment of the parking brake.

On account of the successive production launch and the possibility that in the case of repair, that old replaces new or new replaces old, on **each** vehicle, the version of the pedal assembly (1) is determined before the parking brake is adjusted.

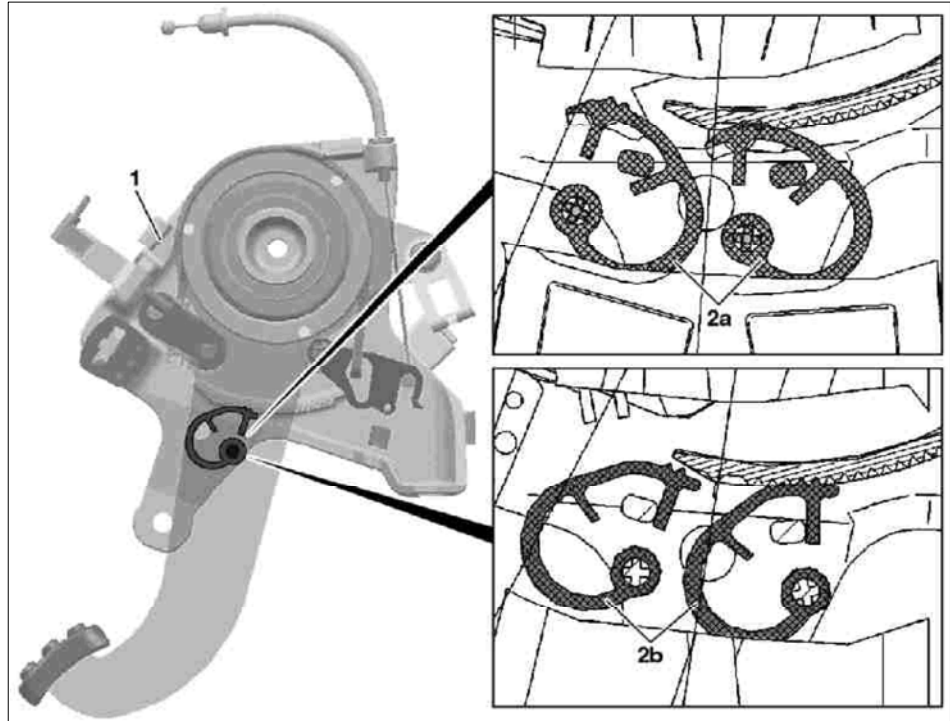

P42.20-2143-06

The new and previous version can be distinguished by the position of the shaft journal (3) in the pedal lever (4). Moreover the notches (2a, 2b) differ in color.

A Late type:

The shaft journal (3) of detent (2a) is mounted offset from the pedal lever center.

Color of notch (2a): light gray

B Previous version:

The shaft journal (3) of the notch (2b) is mounted centrally in the pedal lever (4).

Color of notch (2b): black

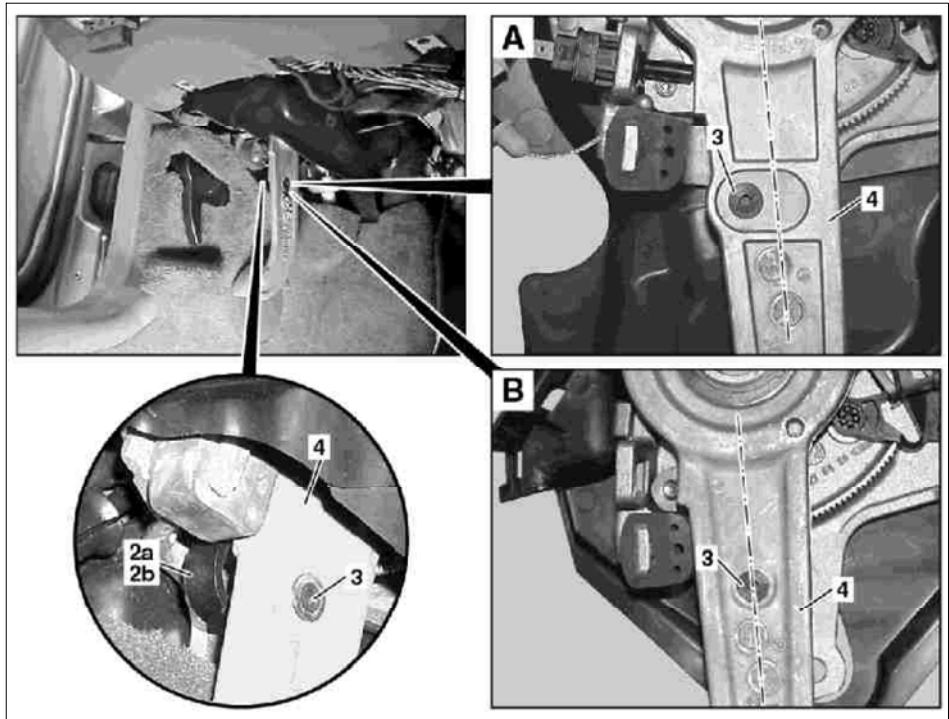

P42.20-2144-06

- 1 Model 140: Detach exhaust system (only as far as necessary).
- 2 Turn detent eccentric bolt (g) to the left using the Allen wrench (approximately half a turn) and simultaneously push backwards in slot until the spring-loaded detent eccentric (b) engages with the raised section (h) in the holddown clip (d).

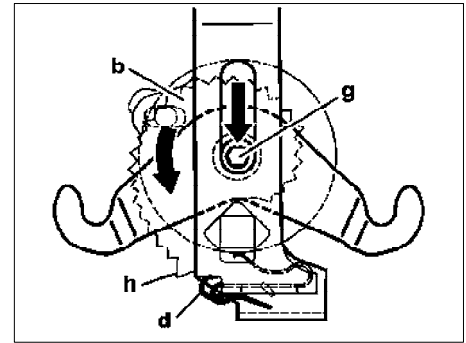

P42.20-0209-01

- 1 Lift center holddown clip (arrow) using a screwdriver so that the cable slack adjuster sets itself automatically.

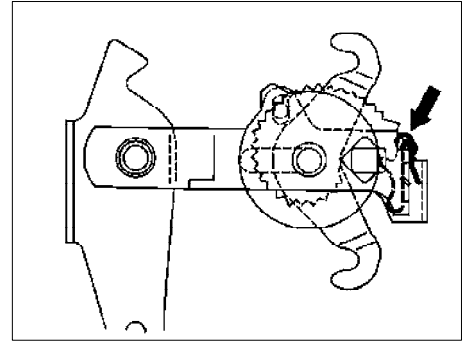

P42.20-0212-01

MODEL 163.113 /128 /136 /154 /157 /172 /174 /175

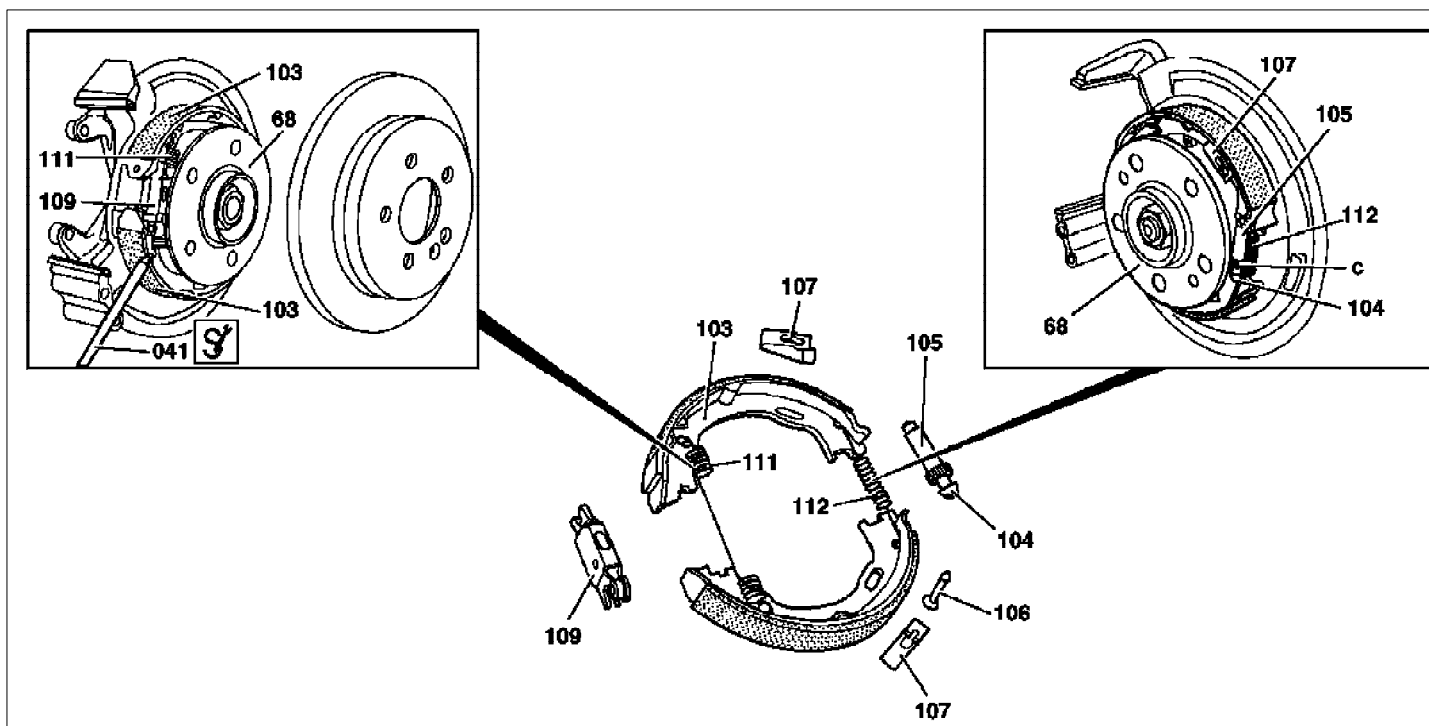



P42.20-0294-09

Shown on vehicle with floating caliper

Modification notes

12.12.02	Notes on safety for lifting platform, included for the first time		AS00.00-Z-0010-01A
12.12.02	Check version of pedal assembly, included for the first time	Step 11	BT42.20-P-0510-01A

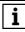
	Remove/Install		
Danger!	Lethal injuries are possible if vehicle slips off of lifting platform	Align vehicle between the columns of the hydraulic hoist and position the four support plates below the hoist support points specified by the vehicle manufacturer.	AS00.00-Z-0010-01A
	Notes on repairs to brake system		AH42.00-P-0003-01A
1 	Remove wheels Remove/install wheels, rotate if necessary		AP40.10-P-4050GH
2	Remove brake disks at rear axle	Vehicle with floating caliper. Vehicle with fixed caliper.	AR42.10-P-0220GH AR42.10-P-0220GI
3	Pre-tension automatic cable slack adjuster		AR42.20-P-0520-01A
4	Unhook retracting spring (111) using removal and installation tool (041)	Installation: Ensure that retracting spring (111) is seated correctly. Removal and installation tool	*116589016200
5	Remove retaining spring (107) and pin (106)	Installation: Ensure that retaining spring (107) is seated correctly	
6	Remove brake shoes (103) over rear axle shaft flange (68)	If brake shoes (103) are burnt, the brake shoes (103), retracting springs (111, 112) and retaining springs (107) and pins (106) must be replaced. Installation: Turn back adjusting mechanism (105) and insert into both brake shoes (103) such that the adjusting wheel (c) points downwards.	
7	Detach retracting spring (112)	Installation: Ensure that retracting spring (112) is seated correctly Coat thread of thrust piece (104) and cylindrical part of adjusting wheel (c) with MB long-term grease. MB long-term grease	*BR00.45-Z-1001-06A

8	Remove expanding lock (109)	 Coat all bearing and sliding surfaces on the expanding lock (109) with MB long-term grease. MB long-term grease	*BR00.45-Z-1001-06A
9	Install in the reverse order		
10	Relieve load on automatic slack adjuster.		AR42.20-P-0520-02A
	Inspecting		
11  BT	Check version of pedal assembly Parking brake pedal assembly modified		BT42.20-P-0510-01A
12	Adjust parking brake		AR42.20-P-0540GH

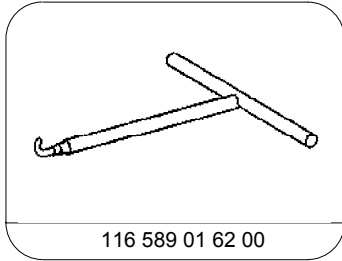

116 589 01 62 00

Removal and installation tool

Repair products

Number	Designation	Order number
BR00.45-Z-1001-06A	MB long-term grease	000 989 63 51